

MPU16102 Magnetic Pickup

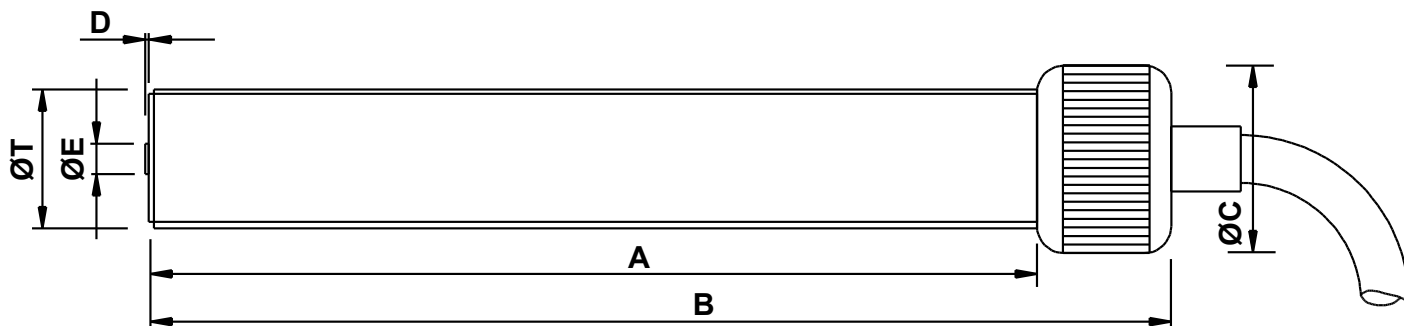

Mechanical specification

dimensions in mm unless otherwise stated

<i>Dimension</i>		<i>Part number</i>
A	102	
B	118 nominal	
ØC	Ø22 medium straight knurled cap	
D	0.4 nominal	
ØE	Ø3.17 pole piece	
ØT	5/8" x 18 tpi UNF-2A	MPU16102-I*
or	M16 x 1.5 6g	MPU16102-M*
Main body material	Stainless steel	
End Bobbin face	Glass filled nylon or Polypropylene	
Locknut	1 off supplied as standard	

*Previous code MPU1163-I / MPU1163-M

mpu16102 full v1.2 01/2020

Electrical specification

Resistance 350 Ω nominal @ 20°C

Inductance 150mH nominal

Operating temperature range -10°C to +85°C

Voltage output 20V peak-peak [see note 1]

Minimum speed 30mm/second [see note 2]

Termination 2-core (7/0.2) screened cable x 2 metres

Notes:

1. Nominal output is a typical peak to peak voltage measured across a 10K load using a 60 tooth mild steel gear wheel of $\varnothing 6"$, rotating at 1000 rpm and with an air gap setting of 0.01".
2. Minimum speed in mm/second to generate 100mV peak to peak typical output under standard test conditions as in note 1.

Reliability, Guaranteed



Logitech Electronics Limited

MADE IN THE UK

mpu16102 full v1.2 01/2020

SENSORMATIC
SPECIALIST & SOLUTIONS

Sensormatic srl - Via della Beverara 13 - 40131 Bologna - Italia
Tel. +39 051 63 53 511 - smbox@sensormatic.it - www.sensormatic.it